

2010-2011 RESIDENTIAL PROPERTIES

Parcel ID Number	Address	Comments	Lot Size	Land Value
09-160-015-477-004-00	104 Picard Street		50' x 100'	\$ 4,500
09-160-015-477-010-00	315 Atlantic Street		50' x 100'	\$ 4,500
09-160-016-334-008-00	N.W. Corner Spruce & Curtis	landlocked	33' x 100'	\$ 2,640
09-160-017-454-015-00	201 E. North Union		50' x 100'	\$ 8,607
09-160-017-454-021-00	207 E. North Union		3.62 acres	\$ 48,870
09-160-020-132-011-00	703 N. Erie Street		25' x 100'	\$ 1,381
09-160-020-207-001-00	608 N. Dean Street	potential riverbed underneath	100' x 131'	\$ 8,012
09-160-020-210-012-00	505 N. Dean Street	landlocked	50' x 74'	\$ 731
09-160-020-458-008-00	306 E. Thomas		50' x 50'	\$ 2,210
09-160-022-177-046-00	1808 1/2 Woodside Court	landlocked	33' x 92'	\$ 1,424
09-160-022-202-013-00	Woodside Avenue		68' x 229'	\$ 5,881
09-160-022-402-003-00	2165 First Street		95' x 120'	\$ 10,047
09-160-028-336-012-00	411 17th Street		35' x 50'	\$ 866
09-160-028-347-005-00	717 Fraser Street		50' x 50'	\$ 1,114
09-160-033-327-001-00	1001 Jennison Street		45' x 150'	\$ 1,950

104 Picard



[Return to Main Page](#)

315 Atlantic Street

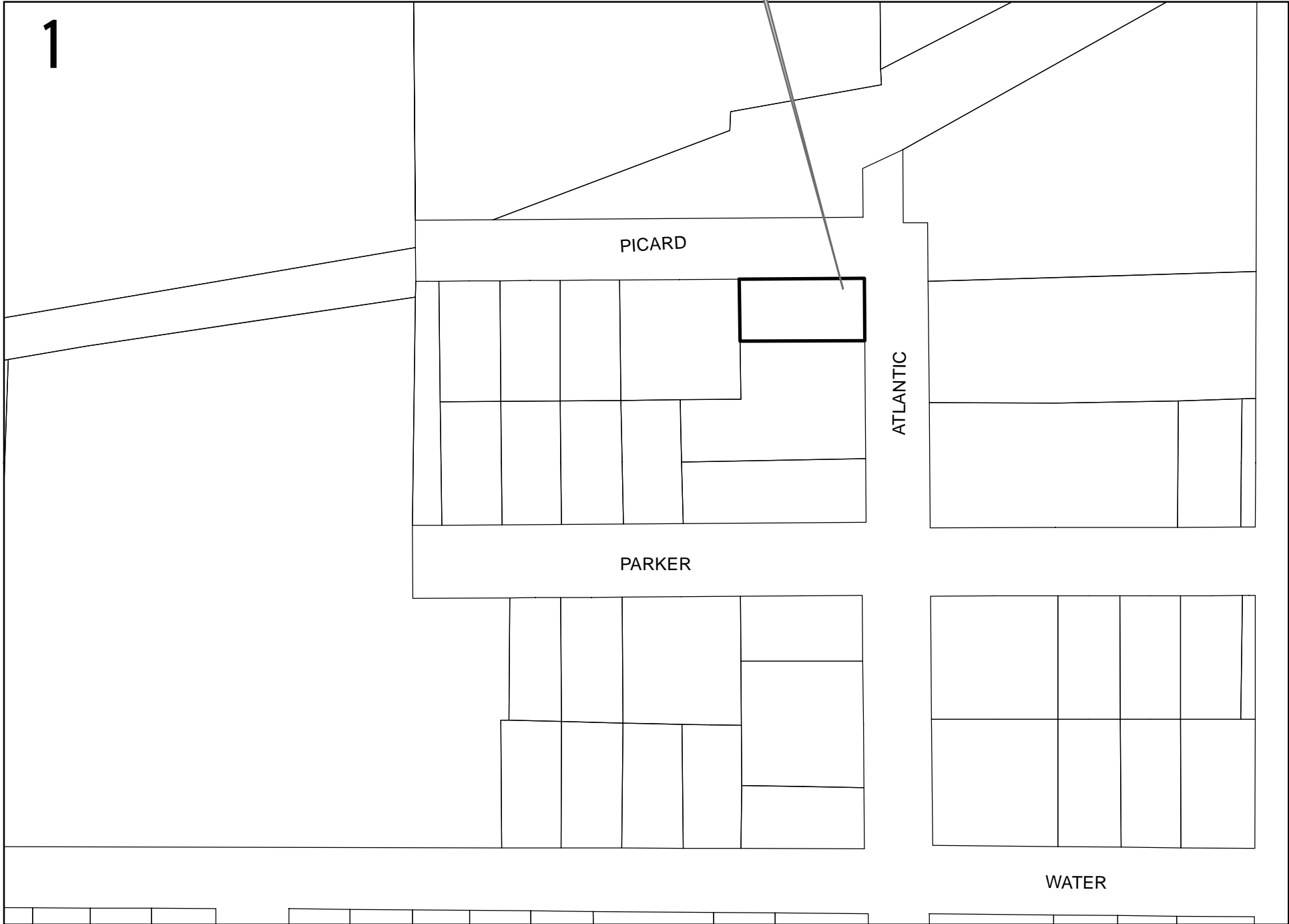

[Return to Main Page](#)

NW Corner Spruce & Curtis

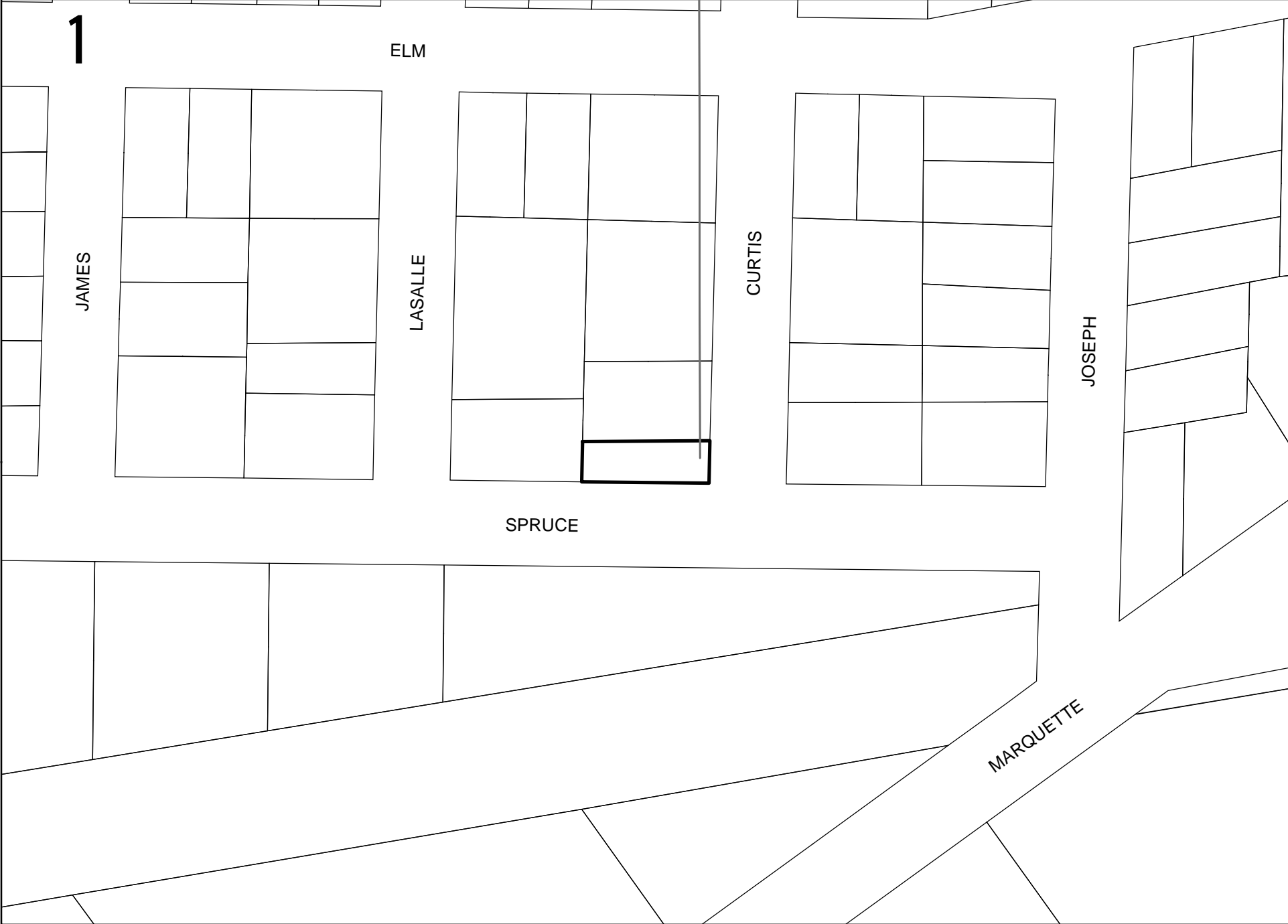

1

WENONA

DEWITT

N. UNION

DEAN

DEAN

MAPLE



207 E. North Union



[Return to Main Page](#)

703 N. Erie



[Return to Main Page](#)

608 N. Dean



[Return to Main Page](#)

505 N. Dean



1

DEWITT

WILLIAM

THOMAS

DEAN

CATHERINE

THOMAS

[Return to Main Page](#)

1808 1/2 Woodside Court

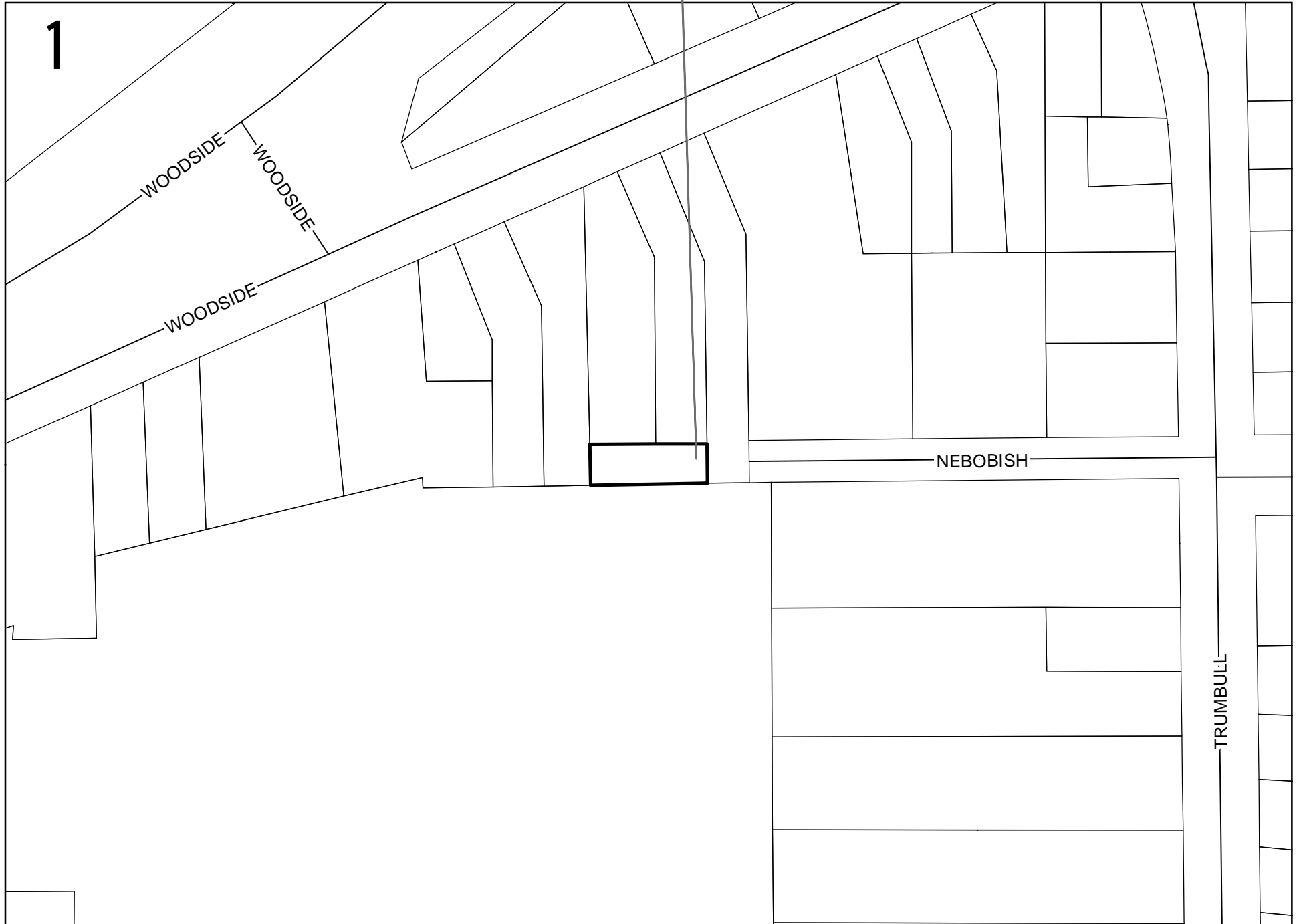

[Return to Main Page](#)

Woodside Avenue



[Return to Main Page](#)

2165 1st Street



[Return to Main Page](#)

411 17th Street



[Return to Main Page](#)

717 Fraser Street

1

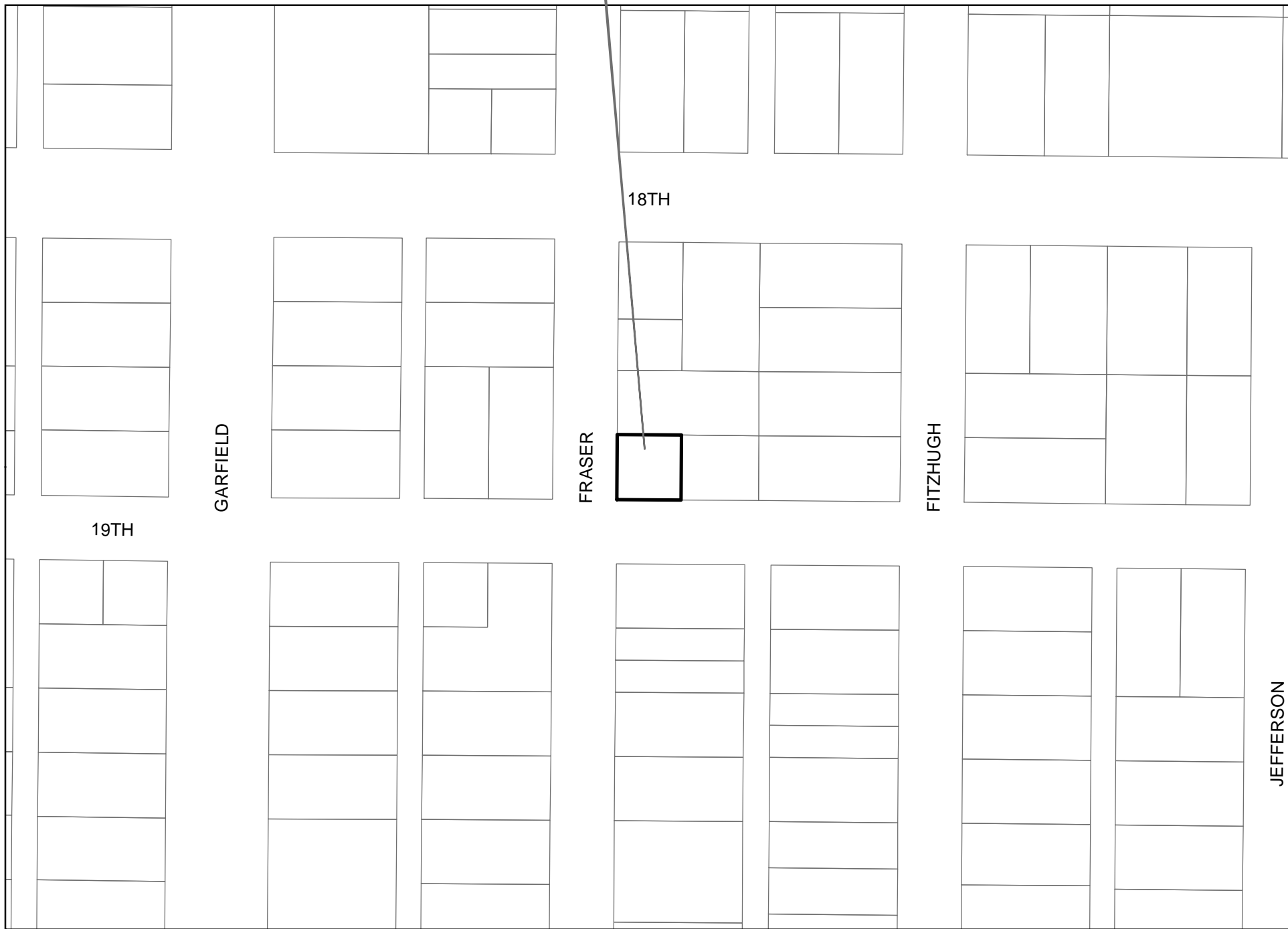

JEFFERSON

[Return to Main Page](#)

1001 Jennison Street

1

